

AIR FORCE T.O. 35C2-3-442-14
ARMY TM5-6115-600-24P
NAVY NAVFAC P-8-628-24P
MARINE CORPS SL-4-07464B

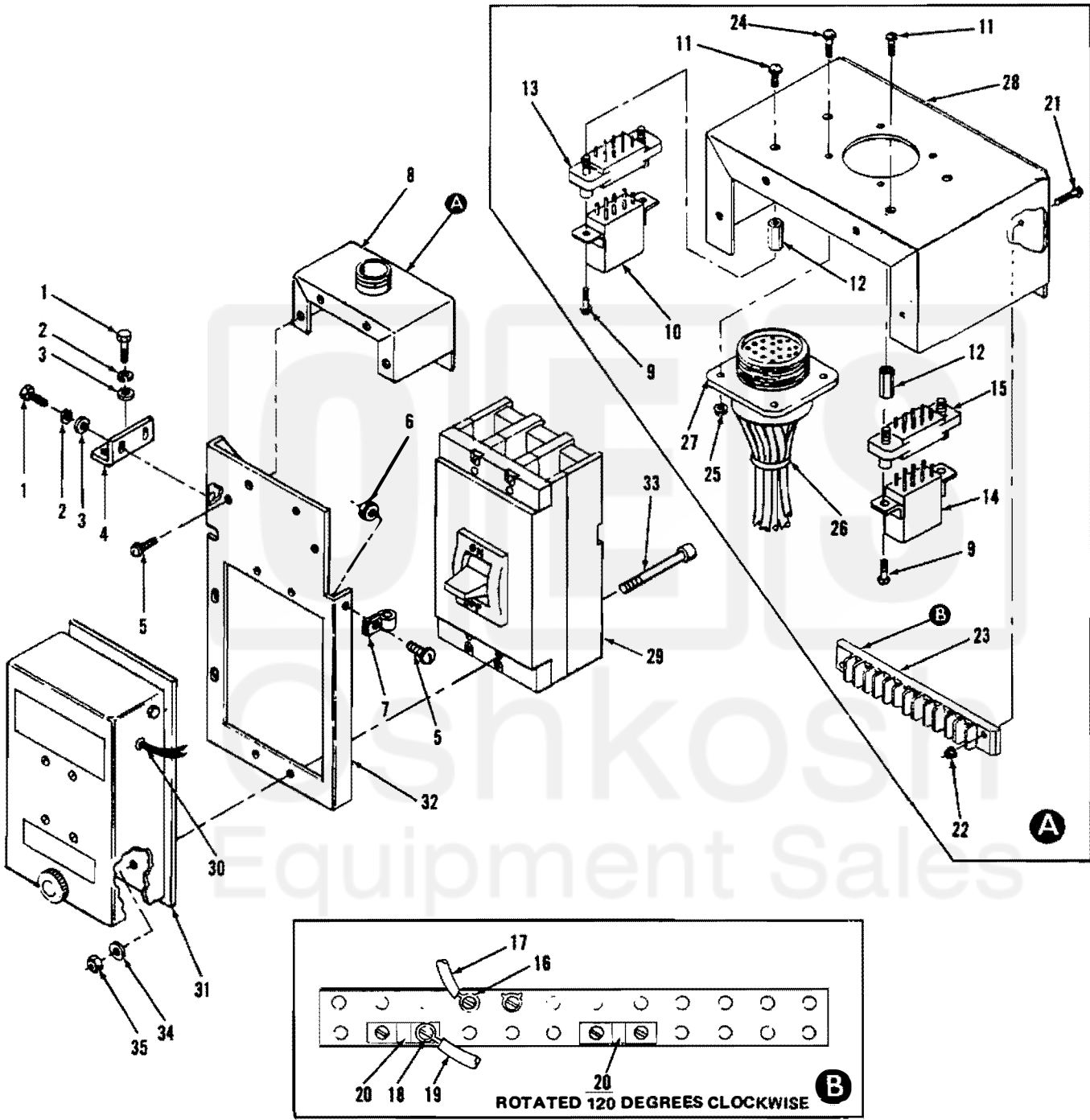

Figure 27. Circuit Breaker Assembly

SECTION II. REPAIR PARTS FOR ORGANIZATIONAL, INTERMEDIATE (FIELD)
 (DIRECT AND GENERAL SUPPORT) AND DEPOT MAINTENANCE

(1) ILLUS- TRATION		(2) SMR CODE				(3) USMC		(4)	(5) DESCRIPTION		(6)	(7)	(8)
a	b	a	b	c	d	a	b	NATIONAL STOCK NUMBER	REF NUMBER & MFR CODE	USABLE ON CODE	U/M	QTY INC IN UNIT	USMC QTY PER EQUIP
FIG NO.	ITEM NO.	ARMY	AIR FORCE	NAVY	USMC	SSI	REPL FACTOR						
									GROUP 04 - AC ELECTRICAL CONTROL SYSTEM				
27		PAOFF	PAOFF	PAFFF	PAFFF		.050	5925-01-048-7656	CIRCUIT BREAKER ASSEMBLY 76-4191	30554	EA	1	1
27	1	PAOZZ	PAOZZ	PAFZZ	PAFZZ	D	.008	5306-00-225-8497	SCREW, HEXHEAD MS90725-32	96906	EA	6	28
27	2	PAOZZ	PAOZZ	PAFZZ	PAFZZ	D	.010	5310-00-081-4219	WASHER, FLAT MS27183-12	96906	EA	6	62
27	3	PAOZZ	PAOZZ	PAFZZ	PAFZZ	D	.010	5310-00-407-9566	WASHER, LOCK MS35338-45	96906	EA	6	67
27	4	MOO	MOO	MOO	MOO				BRACKET 76-4192	30554	EA	1	1
27	5	PAFZZ	PAFZZ	PAFZZ	PAFZZ	D	.008	5305-00-177-5778	SCREW AND WASHER 69-606-49 303737	30554 32195	EA	5	5
27	6	PAFZZ	PAFZZ	PAFZZ	PAFZZ	D	.008	5310-00-094-3421	NUT AND WASHER 69-561-4 511-101800-00	30554 78189	EA	5	95
27	7	PAFZZ	PAFZZ	PAFZZ	PAFZZ	D	.008	5340-00-079-7837	CLAMP MS21333-67	96906	EA	1	1
27	8	AFF	AFF	AFF	AFF				RELAY BOX ASSY 76-4172	30554	EA	1	1
27	9	PAFZZ	PAFZZ	PAFZZ	PAFZZ	D	.008	5305-00-036-6967	SCREW AND WASHER 69-662-16 61-060441-10-0142B- 0542B	30554 78189	EA	4	14
27	10	PAFZZ	PAFZZ	PAFZZ	PAFZZ		.050	5945-00-435-1833	RELAY, K26 MS757/23-003	81349	EA	1	8
27	11	PAFZZ	PAFZZ	PAFZZ	PAFZZ	D	.008	5305-00-036-6969	SCREW AND WASHER 69-662-19 61-060741-40-0142B- 0542B	30554 78189	EA	4	8
27	12	XB	XB	XB	XB				STANDOFF 76-4199 8397-A-0632	30554 06540	EA	2	4
27	13	PAFZZ	PAFZZ	PAFZZ	PAFZZ	D	.008	5935-00-210-8648	SOCKET, RELAY 69-547 VB8/UUA11-80	30554 05574	EA	1	2
27	14	PAFZZ	PAFZZ	PAFZZ	PAFZZ		.050	5945-01-015-0354	RELAY, K27 MS27401-14	96906	EA	1	1
27	15	PAFZZ	PAFZZ	PAFZZ	PAFZZ	D	.008	5935-01-130-3899	SOCKET, RELAY MI2883/41-01	81349	EA	1	1
27	16	PAFZZ	PAFZZ	PAFZZ	PAFZZ	D	.050	5940-00-204-8966	LUG, TERMINAL MS25036-102	96906	EA	14	80
27	17	PAFZZ	PAFZZ	PAFZZ	PAFZZ	D	.080	6145-00-578-6605	WIRE, ELECTRICAL MS086/2-16-9	81349	FT	2	1178
27	18	PAFZZ	PAFZZ	PAFZZ	PAFZZ	D	.050	5940-00-283-5280	LUG, TERMINAL MS25036-106	96906	EA	8	268
27	19	PAFZZ	PAFZZ	PAFZZ	PAFZZ	D	.080	6145-00-578-6602	WIRE, ELECTRICAL MS086/2-18-9	81349	FT	2	144
27	20	PAFZZ	PAFZZ	PAFZZ	PAFZZ	D	.008	6150-00-632-7234	JUMPER 69-651-1 600J	30554 75382	EA	2	2
27	21	PAFZZ	PAFZZ	PAFZZ	PAFZZ	D	.008	5305-00-036-6976	SCREW AND WASHER 69-662-21 61-061041-0142B-0542B	30554 78189	EA	2	12

ARMY TM5-6115-600-24P
 NAVY NAVFAC P-8-628-24P
 MARINE CORPS SL-4-07464B

SECTION II. REPAIR PARTS FOR ORGANIZATIONAL, INTERMEDIATE (FIELD)
 (DIRECT AND GENERAL SUPPORT) AND DEPOT MAINTENANCE

(1) ILLUSTRATION		(2) SMR CODE				(3) USMC		(4)	(5) DESCRIPTION		(6)	(7)	(8)
a	b	a	b	c	d	a	b	NATIONAL STOCK NUMBER	REF NUMBER & MFR CODE	USABLE ON CODE	U/M	QTY INC IN UNIT	USMC QTY PER EQUIP
FIG NO.	ITEM NO.	ARMY	AIR FORCE	NAVY	USMC	SSI	REPL FACTOR						
27									GROUP 04 - AC ELECTRICAL CONTROL SYSTEM - CONTINUED				
27	22	PAFZZ	PAFZZ	PAFZZ	PAFZZ	D	.008	5310-00-063-7300	NUT AND WASHER 69-561-2	30554	EA	2	73
27	23	PAFZZ	PAFZZ	PAFZZ	PAFZZ	D	.003	5940-00-983-6053	TERMINAL BOARD, TB1 57TB-12	81349	EA	1	1
27	24	PAFZZ	PAFZZ	PAFZZ	PAFZZ	D	.008	5305-00-036-6903	SCREW AND WASHER 69-662-4 61-040741-40-0142B-0542B	30554 78189	EA	4	60
27	25	PAFZZ	PAFZZ	PAFZZ	PAFZZ	D	.008	5310-00-836-3520	NUT AND WASHER 69-561-1 511-041800-00	30554 78189	EA	4	66
27	26	PAFZZ	PAFZZ	PAFZZ	PAFZZ	D	.008	5975-00-727-5153	STRAP, TIE DOWN MS3367-4-9	96906	EA	24	239
27	27	PAFZZ	PAFZZ	PAFZZ	PAFZZ	D	.050	5935-00-755-2787	CONNECTOR, M1 MS3102R20-29P	96906	EA	1	2
27	28	XB	XB	XB	XB				RELAY BOX, WELDED 76-4173	30554	EA	1	1
27	29	PAFZZ	PAFZZ	PAFZZ	PAFZZ		.050	5925-01-050-9661	CIRCUIT BREAKER, CB2 76-4182-01	30554	EA	1	1
27	30	PAFZZ	PAFZZ	PAFZZ	PAFZZ	D	.080	6145-00-578-6605	WIRE, ELECTRICAL MS0862-16-9	81349	FT	6	1178
27	31	PAFZZ	PAFZZ	PAFZZ	PAFZZ		.030	6110-01-052-8081	MOTOR CONTROL 76-4193 63030-211-50	30554 12670	EA	1	1
27	32	XB	XB	XB	XB				BRACKET 76-4170	30554	EA	1	1
27	33	PAFZZ	PAFZZ	PAFZZ	PAFZZ	D	.008	5305-00-207-2715	SCREW, CAP, SOCKETHEAD 1/4 X 20 X 3.5 LONG 5174C	93742 15434	EA	4	4
27	34	PAFZZ	PAFZZ	PAFZZ	PAFZZ	D	.010	5310-00-809-1098	WASHER, FLAT MS27183-10	96906	EA	4	252
27	35	PAFZZ	PAFZZ	PAFZZ	PAFZZ	D	.008	5310-00-088-1251	NUT, SELF-LOCKING MS51922-1	96906	EA	4	4